

\$359,000 - 36 Presnell Circle, Beaufort

MLS #190500

\$359,000

4 Bedroom, 3.00 Bathroom, 1,462 sqft
Residential on 0.75 Acres

Shell Point, Beaufort, SC

Update coming soon!! To be built custom lowcountry home. New 36 Presnell is located in Shell Point, private yet close to everything!! Brand new four bedrooms plus two and half baths, over 1400 square feet with a private mother-in-law suite. Interior finishes include granite countertops, stainless appliances, LVP flooring, carpet in the bedrooms, brush nickel hardware throughout. Lot measurements 76.2 width x 468 feet deep, close to 3/4 of an acre. This spacious outdoor living could also allow for a future garage! Breaking ground July 2025! Schools near by Riverview & Bridges. Downtown Beaufort & Port Royal are just 10 minutes away

Built in 2026

Essential Information

MLS #	190500
Price	\$359,000
Bedrooms	4
Bathrooms	3.00
Full Baths	2
Half Baths	1
Square Footage	1,462
Acres	0.75
Year Built	2026
Type	Residential
Sub-Type	Single Family Residence
Style	Ranch

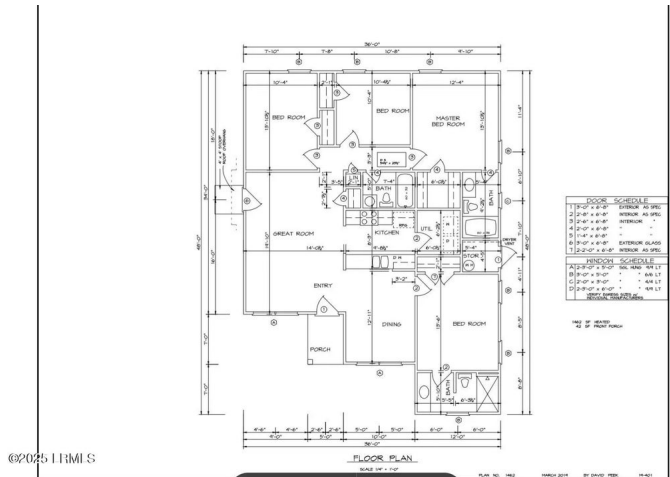

Status Pending

Community Information

Address 36 Presnell Circle
Area Burton
Subdivision Shell Point
City Beaufort
County Beaufort
State SC
Zip Code 29902

Amenities

Garages None
Waterfront None

Interior

Appliances Dishwasher, Disposal, Elec/Oven/Range, Refrigerator, Unfurnished
Heating Heat Pump
Cooling Heat Pump

Exterior

Exterior Vinyl Siding
Roof Composition
Construction Vinyl Siding
Foundation Slab

Additional Information

Zoning Residential

Listing Details

Listing Agent Alice Burke
Listing Office Coldwell Banker Access Realty

Data last updated: October 14th, 2025 at 10:02am EDT and updating occurs every 15 minutesÂ© 2024 Low Country Regional Multiple Listing Service. Information is deemed reliable but not guaranteed. Information is provided exclusively for the consumer's personal, non-commercial use, and may not be used for any purpose other than to identify prospective properties consumers may be interested in purchasing.